

# STREAMLINE WORKFLOWS WITH AUTOMATION AND SECURED CLOUD CONNECTIVITY

Canon's high performing imageRUNNER ADVANCE DX 6980i is an A3 multifunction device that improves business efficiency by delivering fast, high quality black and white prints suited to fast paced office environments.

Canon imageRUNNER ADVANCE DX  
6980i

Mono Multifunction Device ●○



## PRODUCTIVITY

**Save time and resources with increased workflow productivity**

- A3 mid-to-high-volume mono device with a printing speed up to 80ppm.
- Intuitive, user-friendly interface with a large 10.1 inch WSVGA touchscreen and smartphone similarities.
- Advanced scanning technology can dramatically reduce time spent naming and saving scanned files to your cloud storage service<sup>^</sup>.
- Single-pass duplex document feeder and automatic blank page removal for streamlines digital workflows. Scan and convert documents to searchable digital files in a variety of file formats.
- Hot Folders allow users to drag and drop a file into a hot folder and automatically print with pre-defined settings such as number of copies and finishing requirements.

## COST CONTROL

**Improving operation efficiencies and better managing costs**

- Forced job hold with ability to change print settings at device enhances control over projects.
- Blank page removal eliminates paper wastage and helps with document formatting.
- Support for multiple user authentication methods and usage tracking.

## SECURITY

**Safeguard data and ensure sensitive information remains secure**

- The device boot process, firmware, and applications are verified on start up, and self repairs<sup>#</sup>.
- Drive Lock and standard SSD encryption by default, for peace of mind over stored data. Initialize All Data/Settings feature allows admins to easily remove user data at decommissioning.
- Class leading security support of TPM 2.0, TLS 1.3, HCD-PP, FIPS140-2 and SP800-193 compliant, as well as Security Information and Event Management (SIEM) support for real-time insights to potential threats.
- Industry leading malware protection utilising McAfee Embedded Control powered by Trellix, which protects against the execution of unauthorised applications and other cybersecurity threats.

## MOBILITY

**Achieve ultimate freedom and flexibility with Expanded Mobile OS Support**

- Mobile workflows are fully supported with Apple® Airprint®, Android™ Mopria™ and Canon PRINT Business app for iOS/Android. Easily allow users to connect, print, scan and capture.
- Simple and easy connectivity with multiple connection options, USB, ethernet and optional Wi-Fi, plus support for approved USB to LAN adaptors for second ethernet connection.

## SUSTAINABILITY

**Support your environmental goals with MFDs that incorporate responsible design and efficient operations**

- The DX Series makes an increased use of environmentally friendly packaging.
- Canon's fusing technologies minimises power requirements and helps achieve low energy consumption, also helps faster warm-up times.
- Canon is committed to low Typical Energy Consumption (TEC) values. The DX 6980i achieves this through features such as default 2-sided printing, blank page removal, Forced Job Hold and supports light weight GSM paper (down as low as 52 gsm) which means less pulp per page.

## INTEGRATION

**Seamlessly integrate with key line-of-business systems to fast track your digital transformation journey**

- Personalised workflows allow users to pick and choose what works best for them in terms of functionality.
- Canon's powerful Multifunctional Embedded Application Platform (MEAP), combined with a common source code for firmware, ensures that IT and office automation is smoothly aligned.
- Efficiently digitise documents with automated workflows connected to applications such as OneDrive, SharePoint, Concur, DropBox and Microsoft Teams\*.

\* Requires uniFLOW Online Print & Scan or uniFLOW Cloud Image Processing subscription.

# Boot firmware can only be repaired automatically.

# ADVANCED SCANNING

uniFLOW Online's Filing Assist<sup>^</sup> saves you time, reduces keying errors and brings consistency to your filing so you can find what you need, when you need it, anywhere you have internet access; at home, work or on the go.

Filing Assist uses pre-configured workflows that scan batches of repetitive documents including invoices, delivery notes, picking lists and orders to popular cloud services. Not only are they scanned, they are named, converted and filed – based on rules and information from the document.

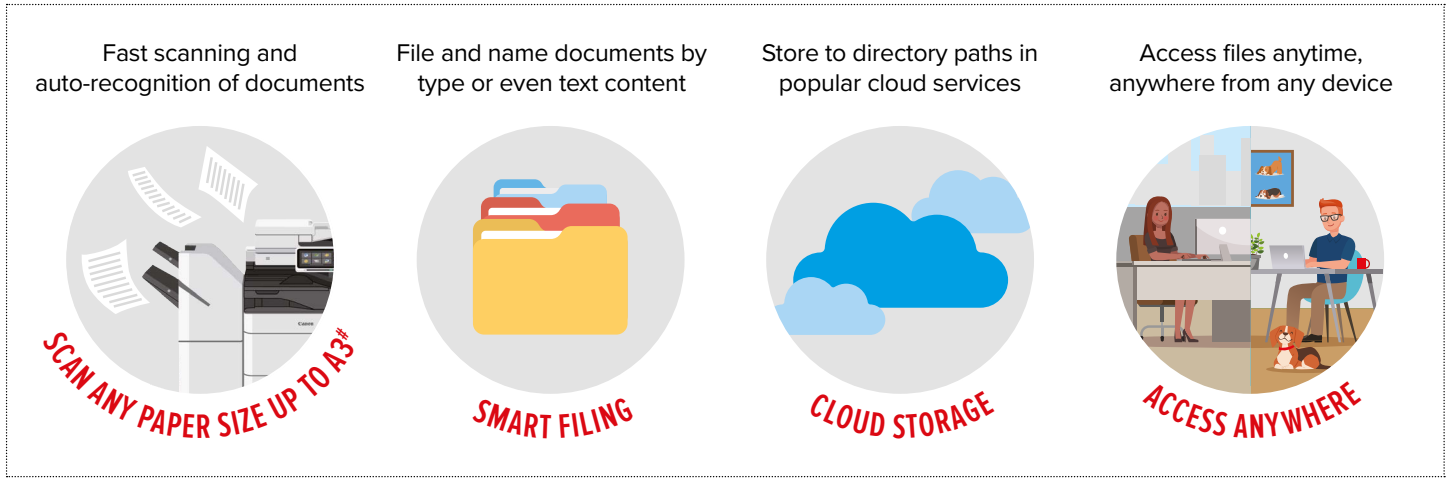

<sup>^</sup> Requires uniFLOW Online Cloud Image Processing subscription.  
<sup>#</sup> Maximum paper size depends on model of MFD.

# CONFIGURATION

This flat configuration is for illustration purposes only.  
 For a complete list of options and the exact compatibility relationships, please refer to the [online product configurator](#).

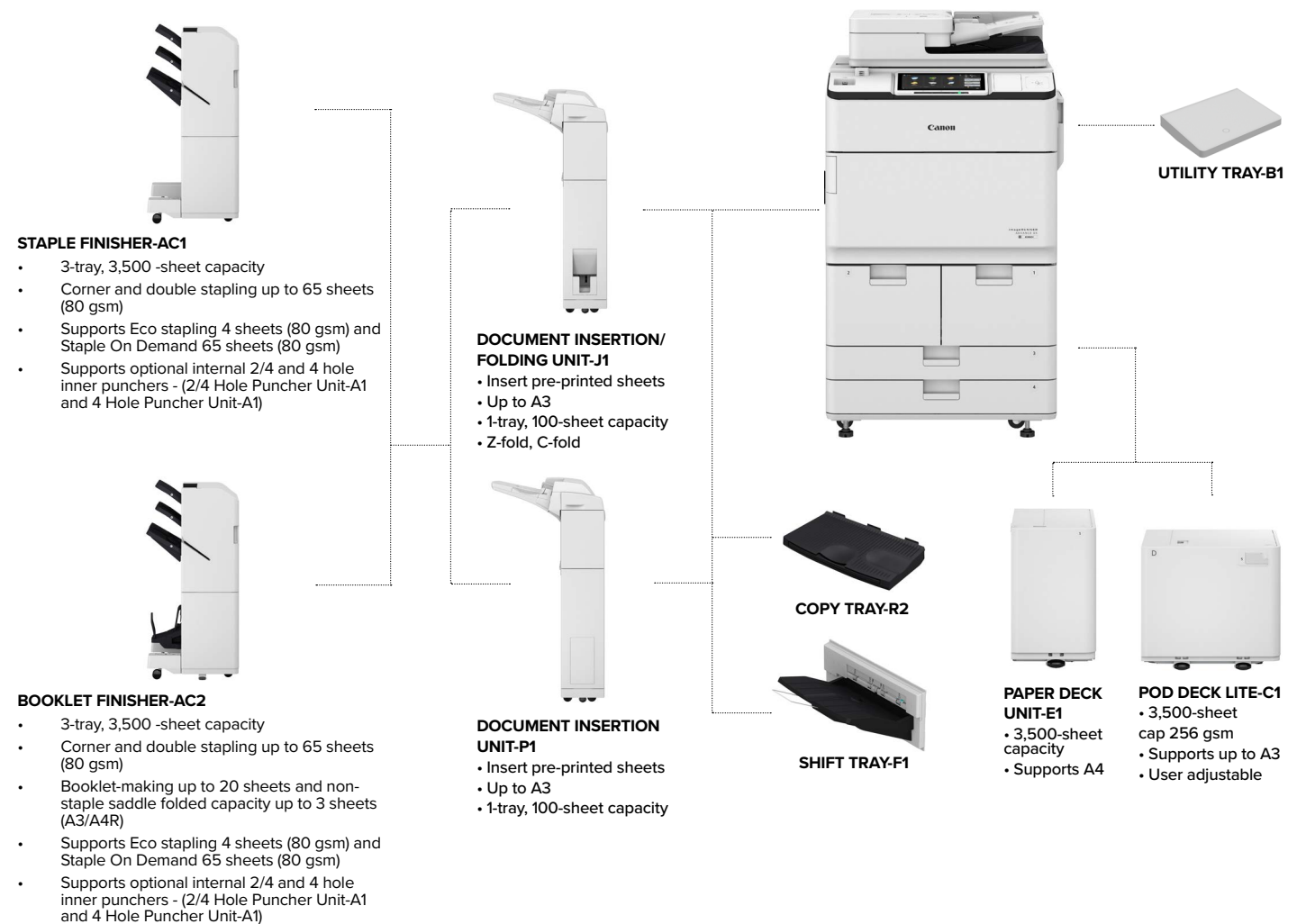

# imageRUNNER ADVANCE DX 6980i Specifications

| Main Unit                                   |  |
|---|--|
| Machine Type                                | A3 Monochrome Laser Multifunctional  |
| Core Function                               | Print, Copy, Scan, Send, Store and Optional Fax  |
| Processor                                   | 1.8GHz Dual Core   |
| Control Panel                               | 10.1" TFT LCD WSVGA Colour Touch Panel   |
| Memory                                      | RAM 4GB  |
| Storage                                     | Standard: 256 GB (SSD)<br>Optional: 1TB (SSD)  |
| Interface Connection                        | Network:<br>Standard: 1000Base-T/100Base-TX/10Base-T<br>Optional: Wi-Fi (IEEE 802.11b/g/n)<br>Others:<br>Standard: USB 2.0 x 1 (Host), USB 3.0 x 1 (Host), USB 2.0 x 1 (Device)<br>Optional: Serial Interface, Copy Control Interface  |
| Paper Supply Capacity (A4, 80gsm)           | Standard: 4,200 Sheets<br>100-Sheets: Multi-purpose Tray x 1<br>1,500-Sheets: Paper Deck x 2<br>550-Sheets: Paper Cassette x 2<br>Maximum: 7,700 sheets (with POD Deck Lite-C1 or Paper Deck Unit-E1)  |
| Paper Output Capacity (A4, 80gsm)           | Standard: 250 Sheets (with Copy Tray-R2)<br>Maximum: 3,500 Sheets (with Staple Finisher-AC1 or Booklet Finisher-AC2)   |
| Finishing Capabilities                      | Collate, Group, Offset, Staple, Saddle Stitch, Hole Punch, Eco Staple, Staple On Demand, Document Insertion, Z-fold, C-fold<br>(Finishing capabilities vary depending on the options connected.)   |
| Supported Media Types                       | Multi-purpose Tray:<br>Thin, Plain, Recycled, Colour, Heavy, Tracing, Bond, Transparency, Label, Pre-punched, Letterhead, Tab<br>Paper Decks (Left/Right):<br>Thin, Plain, Recycled, Colour, Heavy, Bond, Pre-punched, Letterhead<br>Paper Cassettes (Upper/Lower):<br>Thin, Plain, Recycled, Colour, Heavy, Bond, Pre-punched, Letterhead, Tab*<br>*Tab Feeding Attachment-B1 is required.  |
| Supported Media Sizes                       | Multi-purpose Tray:<br>Standard Size: A3, A4, A4R, A5 <sup>1</sup> , A5R, A6R <sup>2</sup> , B4, B5, B5R<br>Custom Size: 100.0 x 148.0 mm to 297.0 x 487.7 mm<br>Free Size: 100.0 x 148.0 mm to 297.0mm x 487.7mm<br><sup>1</sup> Supported media weights: more than 64 gsm<br><sup>2</sup> Supported media weights: more than 91 gsm<br>Paper Decks (Left/Right):<br>Standard Size: A4, B5<br>Paper Cassettes (Upper/Lower):<br>Standard Size: A3, A4, A4R, A5R, B4, B5, B5R<br>Custom Size: 139.7 x 182.0 mm to 297 x 487.7 mm   |
| Supported Media Weights*                    | Multi-purpose Tray: 52 to 256 gsm<br>Paper Decks (Left/Right): 52 to 220 gsm<br>Paper Cassettes (Upper/Lower): 52 to 220 gsm<br>Duplex: 52 to 220 gsm<br>*For details of supported media, refer to the 'Available Paper' in the <a href="#">User Manual</a>  |
| Warm-up Time                                | Quick Start-up Mode: 4 Seconds or less <sup>1</sup><br><sup>1</sup> Time from device power-on to when the copy icon appears and is enabled to operate on the touch panel display<br>From Sleep Mode: 30 Seconds or Less<br>From Power On: 30 seconds or less <sup>2</sup><br><sup>2</sup> Time from device power-on, until copy ready(not print reservation)   |
| Dimensions (W x D x H)                      | 670 x 770 x 1,185 mm   |
| Installation Space                          | Depends on configuration. Please refer to the <a href="#">online product configurator</a>  |
| Weight                                      | Approx. 219 kg (including toner bottle)  |
| Print Specifications                        |  |
| Print Speed                                 | Up to 80 ppm (A4), Up to 40 ppm (A3), Up to 58 ppm (A4R), Up to 35 ppm (A5R)   |
| Print Resolution (dpi)*                     | 1,200 x 1,200  |
| *Laser Resolution                           |  |
| Page Description Languages                  | Standard: UFR II, PCL6<br>Option: Adobe® PostScript® 3 <sup>1</sup>  |
| Direct Print                                | Supported file types: PDF, EPS, TIFF/JPEG, XPS   |
| Printing from Mobile and Cloud Applications | AirPrint <sup>SM</sup> , Mopria <sup>SM</sup> , Canon PRINT Business, uniFLOW Online and Universal Print.<br>A range of software and MEAP-based solutions are available to provide printing from mobile devices or internet-connected devices and cloud-based services depending on your requirements.<br>Please contact your sales representative for further information.  |
| OS Standard Printing                        | Android <sup>SM</sup> /Windows <sup>SM</sup> 10 <sup>1</sup> , Windows <sup>SM</sup> 11 <sup>1</sup> , Chrome OS <sup>SM</sup> , macOS (11.2.2 or later) <sup>2</sup> , iOS (15.2 or later) <sup>2</sup> , iPadOS <sup>2</sup><br><br><sup>1</sup> Need to select the [Use Mopria] check box (Check the online user manual for details)<br><sup>2</sup> Need to select the [Use AirPrint] check box (Check the online user manual for details) <sup>1</sup>  |
| Fonts                                       | PS Fonts: 136 Roman<br>PCL Fonts: 93 Roman, 10 Bitmap fonts, 2 OCR fonts, Andalé Mono WT J/K/S/T <sup>1</sup> (Japanese, Korean, Simplified and Traditional Chinese), Barcode fonts <sup>2</sup><br><sup>1</sup> Optional PCL International Font Set-A1 is required.<br><sup>2</sup> Optional Barcode Printing Kit-D1 is required.   |
| Print Features                              | Secured Print, Secure Watermark, Header/Footer, Page Layout, 2-sided Printing, Mixed Paper Sizes/Orientations, Front/Back Covers, Toner Reduction, Poster Printing, Forced Hold Printing, Print Date, Scheduled Printing, Printing Using a Virtual Printer, Printing using Hot Folder  |
| Operating System As of Feb. 2023            | UFR II: Windows <sup>SM</sup> 10/Windows <sup>SM</sup> 11/Windows <sup>SM</sup> Server2012/Windows <sup>SM</sup> Server2012 R2 / Windows <sup>SM</sup> Server2016/Windows <sup>SM</sup> Server2019/Windows <sup>SM</sup> Server2022, macOS <sup>SM</sup> (10.13 or later)<br>PCL: Windows <sup>SM</sup> 10/Windows <sup>SM</sup> 11/Windows <sup>SM</sup> Server2012/Windows <sup>SM</sup> Server2012 R2 / Windows <sup>SM</sup> Server2016/Windows <sup>SM</sup> Server2019/Windows <sup>SM</sup> Server2022<br>PS: Windows <sup>SM</sup> 10/Windows <sup>SM</sup> 11/Windows <sup>SM</sup> Server2012/Windows <sup>SM</sup> Server2012 R2 / Windows <sup>SM</sup> Server2016/Windows <sup>SM</sup> Server2019/Windows <sup>SM</sup> Server2022, macOS <sup>SM</sup> (10.13 or later)<br>PPD: Windows <sup>SM</sup> 10/Windows <sup>SM</sup> 11, macOS <sup>SM</sup> (10.13 or later) |
| Copy Specifications                         |  |
| Copy Speed                                  | Up to 80 ppm (A4), Up to 40 ppm (A3), Up to 58 ppm (A4R), Up to 35 ppm (A5R)   |
| First-Copy-Out Time (A4)                    | 3.1 seconds (Approx.)  |
| Copy Resolution (dpi)                       | 600 x 600  |
| Multiple Copies                             | Up to 9,999 copies   |
| Copy Density                                | Automatic or Manual (9 Levels)   |
| Magnification                               | Variable Zoom: 25% to 400% (1% Increments)<br>Preset Reduction/Enlargement: 25%, 50%, 61%, 70%, 81%, 86%, 100%(1:1), 115%, 122%, 141%, 200%, 400%  |
| Copy Features                               | Preset R/E Ratios by Area, 2-Sided, Density Adjustment, Original Type Selection, Interrupt Mode, Book to 2 Pages, 2-sided Original, Job Build, N on 1, Add Cover, Insert Sheets, Different Size Originals, Page Numbering, Copy Set Numbering, Sharpness, Erase Frame, Secure Watermark, Print Date, Gutter, Print & Check, Negative/Positive, Repeat Images, Merge Job Blocks, Mirror Image, Store in Mail Box, Superimpose Image, Copy ID Card, Skip Blank Pages, Free Size Original, Reserved copy, Copy Sample   |

## Scan Specifications

|                                   |  |
|-----------------------------------|--|
| Type                              | Single Pass DADF-C <sup>1</sup><br><sup>1</sup> Detect Feeder Multi Sheet Feed is supported.   |
| Document Feeder                   | Up to 200 Sheets   |
| Paper Capacity (80gsm)            |  |
| Acceptable Originals and Weights* | Platen: Sheet, Book, and 3-Dimensional Objects<br>Document Feeder Media Weight:<br>1-sided Scanning: 38 to 220 gsm (BW, CL)<br>2-sided Scanning: 38 to 220 gsm (BW, CL)<br>*An acceptable weights of A6R or smaller is 50 to 220 gsm |

|  |  |
|--|--|
| Supported Media Sizes                    | Platen Max. Scanning Size: up to 297.0 x 431.8 mm<br>Document Feeder Media Size: A3, A4, A4R, A5, A5R, A6R, B4, B5, B5R, B6R<br>Custom Size: 70.0 x 139.7 mm to 304.8 x 431.8 mm   |
| Scan Speed (ppm, BW and CL; A4)          | 1-sided Scanning: 135/135 (300 x 300 dpi, send), 80/80 (600 x 600 dpi, copy)<br>2-sided Scanning: 270/270 (300 x 300 dpi, send), 160/90 (600 x 600 dpi, copy)  |
| Scan Resolution (dpi)                    | Scan for Copy: 600 x 600<br>Scan for Send: (Push) 600 x 600 (SMB/FTP/WebDAV/IFAX), (Pull) 600 x 600<br>Scan for Fax: 600 x 600   |
| Pull Scan Specifications As of Feb. 2023 | Color Network ScanGear2. For both TWAIN and WIA<br>Supported OS: Windows <sup>SM</sup> 10/Windows <sup>SM</sup> 11/Windows <sup>SM</sup> Server2012/Windows <sup>SM</sup> Server2012 R2 / Windows <sup>SM</sup> Server2016/Windows <sup>SM</sup> Server2019/Windows <sup>SM</sup> Server2022 |
| Scan Method                              | Push Scan, Pull Scan, Scan to Box, Scan to Advanced Box, Scan to Network, Scan to USB Memory Key, Scan to Mobile Devices, Scan to Cloud (requires uniFLOW Online)  |

## Send Specifications

|                         |   |
|-------------------------|---|
| Destination             | Standard: E-mail/Internet FAX (SMTP), SMB, FTP, WebDAV, Mail Box<br>Optional: Super G3 FAX, IP Fax  |
| Address Book            | LDAP (2,000)/Local (1,600)/Speed Dial (200)   |
| Send Resolution (dpi)   | Push: Up to 600 x 600<br>Pull: Up to 600 x 600  |
| Communication Protocol  | File: FTP(TCP/IP), SMB3.11 (TCP/IP), WebDAV<br>E-mail/Fax: SMTP, POP3   |
| File Format             | Standard: TIFF (MMR), JPEG <sup>1</sup> , PDF (Compact, OCR (Text Searchable), Optimize PDF for Web, Format to PDF/A-1b, Trace & Smooth, Encrypt), XPS (Compact, OCR (Text Searchable)), PDF/XPS (Device Signature, User Signature), Office Open XML (PowerPoint, Word)<br><sup>1</sup> Single-Page only.         |
| Universal Send Features | Original Type Selection, 2-sided Original, Book to 2 Pages, Different-size Originals, Density Adjustment, Sharpness, Copy Ratio, Erase Frame, Job Build, Delayed Send, Preview, Job Done Notice, File Name, Subject/Message, Reply-to, E-mail Priority, TX Report, Original Content Orientation, Skip Blank Pages |

## Fax Specifications

|                                    |  |
|------------------------------------|--|
| Maximum Number of Connection Lines | 1  |
| Modem Speed                        | Super G3: 33.6 kbps<br>G3: 14.4 kbps   |
| Compression Method                 | MH, MR, MMR, JBIG  |
| Resolution (dpi)                   | 400 x 400 (Ultra Fine), 200 x 400 (Super Fine), 200 x 200 (Fine), 200 x 100 (Normal)   |
| Sending/Receiving Size             | Sending: A3, A4, A4R, A5 <sup>1</sup> , A5R <sup>1</sup> , B4, B5 <sup>1</sup> , B5R <sup>1</sup><br>Receiving: A3, A4, A4R, A5, A5R, B4, B5, B5R<br><sup>1</sup> Sent as A4<br><sup>2</sup> Sent as B4 short  |
| FAX Memory                         | Up to 30,000 pages (2,000 Jobs)  |
| Speed Dials                        | Max. 200   |
| Group Dials/Destinations           | Max. 199 Dials   |
| Sequential Broadcast               | Max. 256 Addresses   |
| Memory Backup                      | Yes  |
| Fax Features                       | Sender's Name (TTI), Selecting the Telephone Line (when sending fax), Direct Send, Delayed Send, Preview, Job Done Notice, TX Report, Interrupt Transmission, Sequential Broadcasting, Password/Subaddress Sending, Confidential Mailbox, 2 on 1 Log |

## Store Specifications

|                                   |   |
|-----------------------------------|---|
| Mail Box (Number Supported)       | 100 User Inboxes,<br>1 Memory RX Inbox,<br>50 Confidential Fax Inboxes<br>Maximum 30,000 Pages (2,000 jobs) Stored  |
| Advanced Box                      | Communication Protocol: SMB or WebDAV<br>Supported Client PC: Windows <sup>SM</sup> 10/Windows <sup>SM</sup> 11<br>Concurrent Connections (Max.): SMB:64, WebDAV:3  |
| Advanced Box Available Disc Space | Standard: 16 GB Approx.<br>(With option: Max. 480GB)  |
| Advanced Box Features             | Authentication for Advanced Box Log-in, Sort Function, Printing a PDF File with a Password, imageWARE Secure Audit Manager Support, Search, File Preview, Authentication Management, Open to public, URI TX, Backup/Restore |

## Security Specifications

|                                   |   |
|-----------------------------------|---|
| Authentication and Access Control | User Authentication (Picture Login, Picture and PIN Login, Card Login, Username and Password Login, Function Level Login, Mobile Login), Department ID Authentication (Department ID and PIN Login, Function Level Login), uniFLOW <sup>SM</sup> (PIN Login, Picture Login, Picture and PIN Login, Card Login, Card and PIN Login, Username and Password Login, Department ID and PIN Login, Function Level Login), Access Management System (Access Control)<br><sup>1</sup> including uniFLOW Online  |
| Document Security                 | Print Security (Secure Print, Encrypted Secure Print, Forced Hold Printing, uniFLOW Secure Print <sup>1</sup> ), Receive Data Security (Confidential Fax In-box Forwarding Received Documents Automatically), Scan Security (Encrypted PDF, Device Signature PDF/XPS, User Signature PDF/XPS, Adobe LiveCycle <sup>SM</sup> Rights Management ES2.5 Integration), BOX Security (Mail Box Password Protected, Advanced Space Access Control), Send Data Security (Setting for requesting password input per transmission, Restricted E-mail File send functions, Confirming FAX number, Allow/Restrict Fax Driver Transmissions, Allow/Restrict Sending from History, S/MIME Support), Document Tracking (Secure Watermark)<br><sup>1</sup> Requires uniFLOW Online/ uniFLOW |
| Network Security                  | TLS 1.3, IPsec, IEEE802.1X authentication, SNMP V3.0, Firewall Functionality (IP/MAC Address Filtering), WPA3 support (Wi-Fi), Dual Network Support (Wired LAN/Wireless LAN, Wired LAN/Wired LAN), Disabling Unused Functions (Enabling/Disabling Protocols/Applications, Enabling/Disabling Remote UI, Enabling/Disabling USB Interface), Communication Line Separation (G3 FAX, USB Port, Advanced Box, Scan and Send -Virus Concerns for E-mail Reception)   |
| Device Security                   | Protecting SSD Data [SSD Data Encryption (FIPS140-2 Validated), SSD Lock], Standard SSD Initialize, Trusted Platform Module v2.0 (TPM), Job Log Conceal Function, Protecting MFD Software Integrity, Checking MFD Software Integrity & Platform Firmware Resiliency (NIST SP800-193) with Verify System at Startup, Automatic Recovery, Runtime Intrusion Detection, Common Criteria Certification(HCD-PP) (pending confirmation)   |
| Device Management and Auditing    | Administrator Password, Digital Certificate and Key Management, Audit Log, Cooperating with External Security Audit System (Security Information and Event Management), Image Data Logging, Security Policy Setting   |

## Environmental Specifications

|                       |  |
|-----------------------|--|
| Operating Environment | Temperature: 10 to 30°C<br>Humidity: 20 to 80 % RH (Relative Humidity)   |
| Power Source          | 220-240V, 50/60Hz, 10A   |
| Power Consumption     | Maximum: Approx. 2,400 W<br>Sleep mode: Approx. 0.9 W <sup>1</sup><br>Typical Energy Consumption (TEC) <sup>2</sup> rating<br>1.56kWh<br><sup>1</sup> 0.9W sleep mode may not be possible in all circumstances due to certain settings.<br><sup>2</sup> As per USA Energy Star version 3.0 |

## Consumables

|                                       |                    |
|---------------------------------------|--------------------|
| Toner Cartridges                      | NP5-54 Toner BLACK |
| Toner (Estimated Yield @ 6% Coverage) | 56,000 pages       |

## Software and Printer Management

|                         |  |
|-------------------------|--|
| Tracking and Reporting  | Universal Login Manager (ULM)<br>uniFLOW Online (Optional)       |
| Remote Management Tools | iW Management Console<br>eMaintenance<br>Content Delivery System |
| Scanning Software       | Color Network ScanGear 2   |
| Optimisation Tools      | Canon Driver Configuration Tool                                  |
| Platform                | MEAP (Multifunctional Embedded Application Platform)             |
| Document Publishing     | iW DESKTOP   |

## Paper Supply Options

|                    |  |
|--------------------|--|
| Paper Deck Unit-E1 | Paper Capacity: 3,500 Sheets (80 gsm)<br>Paper Type: Thin, Plain, Recycled, Colour, Heavy, Bond, Pre-punched, Letterhead<br>Paper Size: A4, B5<br>Paper Weight: 52 to 256 gsm<br>Power Source: from the Main Unit<br>Dimensions (W x D x H): 340 x 630 x 572 mm (attached to the main unit)<br>Weight: Approx. 34 kg   |
| POD Deck Lite-C1   | Paper Capacity: 3,500 Sheets (80 gsm)<br>Paper Type: Thin, Plain, Recycled, Colour, Heavy, Bond, Transparency, Label,<br>Pre-punched, Letterhead, Tab<br>Paper Size: A3, A4, A4R, A5R, B4, B5R, B5<br>Custom Size: 139.7 x 182.0 mm to 297.0 x 487.7 mm<br>Paper Weight: 52 to 256 gsm<br>Power Source: 220-240V, 50/60Hz, 1.2A<br>Dimensions (W x D x H): 633 x 686 x 574 mm (attached to the main unit)<br>Weight: Approx. 68 kg |

## Output Options\*

\* Paper capacity may vary with different paper type/size.

|                                      |  |
|--------------------------------------|--|
| Copy Tray-R2                         | Provides a simple tray for basic output needs.<br>Capacity: 250/100 Sheets (1-sided/2-sided, 80 gsm)<br>Dimensions (W x D x H): 244 (420)* x 382 x 175 mm (*with tray extended)  |
| Shift Tray-F1                        | Provides a simple tray with offset functionality.<br>Capacity: 500 Sheets (Shift delivery)/250 Sheets (Straight delivery), (80 gsm)<br>Dimensions (W x D x H): 366 (486)* x 547 x 256 mm (*with tray extended)   |
| Staple Finisher-AC1                  | Tray Capacity (with 80 gsm paper):<br>Upper Tray: A4, A5, A5R, A6R, B5: approx. 250 Sheets<br>A3, A4R, B4, B5R: approx. 125 Sheets<br>Mid Tray: Same as upper tray<br>Lower Tray: A4, A5, A5R, B5: 3,000 Sheets<br>A3, A4R, B4, B5R: 1,500 Sheets<br>A6R: 250 Sheets<br>Paper Weight: 52 to 256 gsm<br>Staple Position: Corner, Double<br>Staple Capacity:<br>A4, B5: 65 Sheets (52 to 90 gsm),<br>A3, A4R, B4: 40 Sheets (52 to 90 gsm)<br>Eco Staple: A3, A4<br>5 Sheets (52 to 64 gsm)<br>4 Sheets (65 to 81.4 gsm)<br>3 Sheets (82 to 105 gsm)<br>Staple On Demand: 65 sheets (52 to 90 gsm)<br>Power Source: From the main unit<br>Dimensions (W x D x H): 656 mm x 623 mm x 1,195 mm (when the extension tray and rotary tray are extended)<br>Weight: Approx. 36 kg   |
| Booklet Finisher-AC2                 | (Includes the above Staple Finisher-AC1 basic staple specifications.)<br>Saddle Stitch Paper Size: A3, A4R, B4, Custom Size (195.0 x 270.0 mm to 297.0 x 431.8 mm)<br>Saddle Stitch Staple Capacity: 20 sheets x 10 sets (52 to 81.4 gsm) (including 1 cover sheet up to 256 gsm)<br>Non Staple Folded Bunch Capacity: Up to 3 sheets (52 to 105 gsm)<br>Power Source: From the main unit<br>Dimensions (W x D x H): 656 x 623 x 1,195 mm (when the extension tray and rotary tray are extended)<br>Weight: Approx. 60 kg  |
| 2/3 Hole Puncher Unit-A1             | (Requires the Staple Finisher-AC1 or Booklet Finisher-AC2)<br>Two or Three Holes<br>Acceptable Punch Paper Weight: 52 to 256 gsm<br>Acceptable Punch Paper Size:<br>Two holes: A3, A4, A4R, A5, B4, B5, B5R<br>Three holes: A3, A4, B4, B5<br>Power Source: From the finisher  |
| 2/4 Hole Puncher Unit-A1             | (Requires the Staple Finisher-AC1 or Booklet Finisher-AC2)<br>Two or Four Holes<br>Acceptable Punch Paper Weight: 52 to 256 gsm<br>Acceptable Punch Paper Size:<br>Two holes: A3, A4, A4R, A5, B4, B5, B5R<br>Four holes: A3, A4<br>Power Source: From the finisher  |
| 4 Hole Puncher Unit-A1               | (Requires the Staple Finisher-AC1 or Booklet Finisher-AC2)<br>Four Holes<br>Acceptable Punch Paper Weight: 52 to 256 gsm<br>Acceptable Punch Paper Size:<br>Four holes: A3, A4, A4R, A5, B4, B5, B5R<br>Power Source: From the finisher  |
| Document Insertion Unit-P1           | (Requires either the Staple Finisher-AC1 or Booklet Finisher-AC2)<br>Number of Trays: 1<br>Tray Capacity: 100 Sheets (with 80 gsm paper)<br>Acceptable Paper Type:<br>Thin, Plain, Recycled, Colour, Heavy, Coated, Bond, Letterhead, Tab<br>Acceptable Paper Sizes: A3, A4, A4R, B4, B5, B5R<br>Acceptable Paper Weight: 60 to 256 gsm<br>Power Source: 100-240V, 50/60Hz, 1.0A<br>Dimensions (W x D x H): 247 x 679 x 1,242 mm (attached to the device: width excluding document tray)<br>Weight: Approx. 40 kg  |
| Document Insertion / Folding Unit-J1 | (Requires either the Staple Finisher-AC1 or Booklet Finisher-AC2)<br>Number of Trays: 1<br>Supported Folding Type: Z-Fold, C-Fold<br>Acceptable Paper Type:<br>Insertion Unit: Thin, Plain, Recycled, Colour, Heavy, Coated, Bond, Letterhead, Tab<br>Z-Fold/C-Fold: Thin, Plain, Recycled, Colour<br>Acceptable Paper Sizes:<br>Insertion Unit: A3, A4, A4R, B4, B5, B5R<br>Z-Fold: A3, A4R, B4<br>C-Fold: A4R<br>Acceptable Paper Weight:<br>Insertion Unit: 60 to 256 gsm<br>Z-Fold/C-Fold: 60 to 105 gsm<br>Output Capacity (with 80 gsm paper):<br>Insertion: 100 Sheets<br>Z-Fold*: A3, B4: 30 Sheets<br>A4R: 10 Sheets<br>C-Fold: A4R: 40 Sheets<br>*Z-Fold output to the Staple Finisher-AC1 or Booklet Finisher-AC2<br>Power Source: 100-240V, 50/60Hz, 1.0A<br>Dimensions (W x D x H): 247 x 679 x 1,242 mm (attached to the device: width excluding document tray)<br>Weight: Approx. 76 kg |

## Hardware Accessories

|        |   |
|--------|---|
| Others | Utility Tray-B1<br>Tab Feeding Attachment Kit-B1<br>Numeric Keypad-A2<br>Finisher Jogger Kit-A1 |
|--------|---|

## System and Controller Options

|                     |   |
|---------------------|---|
| Print Accessories   | PCL International Font Set-A1<br>PS Printer Kit-BC1                               |
| Barcode Printing    | Barcode Printing Kit-D1   |
| System Accessories  | Serial Interface Kit-K3<br>Copy Control Interface Kit-A1<br>Wireless LAN BOARD-F1 |
| Storage Accessories | 250GB SSD-A1<br>1TB SSD-A1<br>MEMORY Mirroring Kit-A1                             |
| FAX Accessories     | Super G3 FAX Board-AX1<br>Remote Fax Kit-A1<br>IP FAX Expansion Kit-B1            |

## Other Options

|                           |  |
|---------------------------|--|
| Accessibility Accessories | ADF Access Handle-A1<br>Voice Guidance Kit-G1<br>Voice Operation Kit-D1                                |
| Staple Cartridges         | Staple Cartridge-X1<br>Staple Cartridge-Y1   |
| Heater Options            | Reader Heater Unit-P1<br>Cassette Heater Unit-38<br>Paper Deck Heater-A1 (For Side Paper Deck-E1 only) |



Trellix

POWERED BY



<https://www.ddsgroup.com.au/canon-copiers/>

dds  
digital document solutions

1300 174 277